



Satilu Aqf30 aquaponics garden

30 vertical tower system







# Summary

---

- 30 vertical towers
- 2160 growing holes/leafy greens per month
- Up to 300 fish Tilapia in pond
- All year growing
- 50m<sup>2</sup> Polycarbonate greenhouse
- No pesticide, no chemical, no fertilizers
- Automatic climate control
- Heating/colling with HP
- Pink shadowing (increasing growth)

More info on demand

**Investment value: 225,000 EUR**



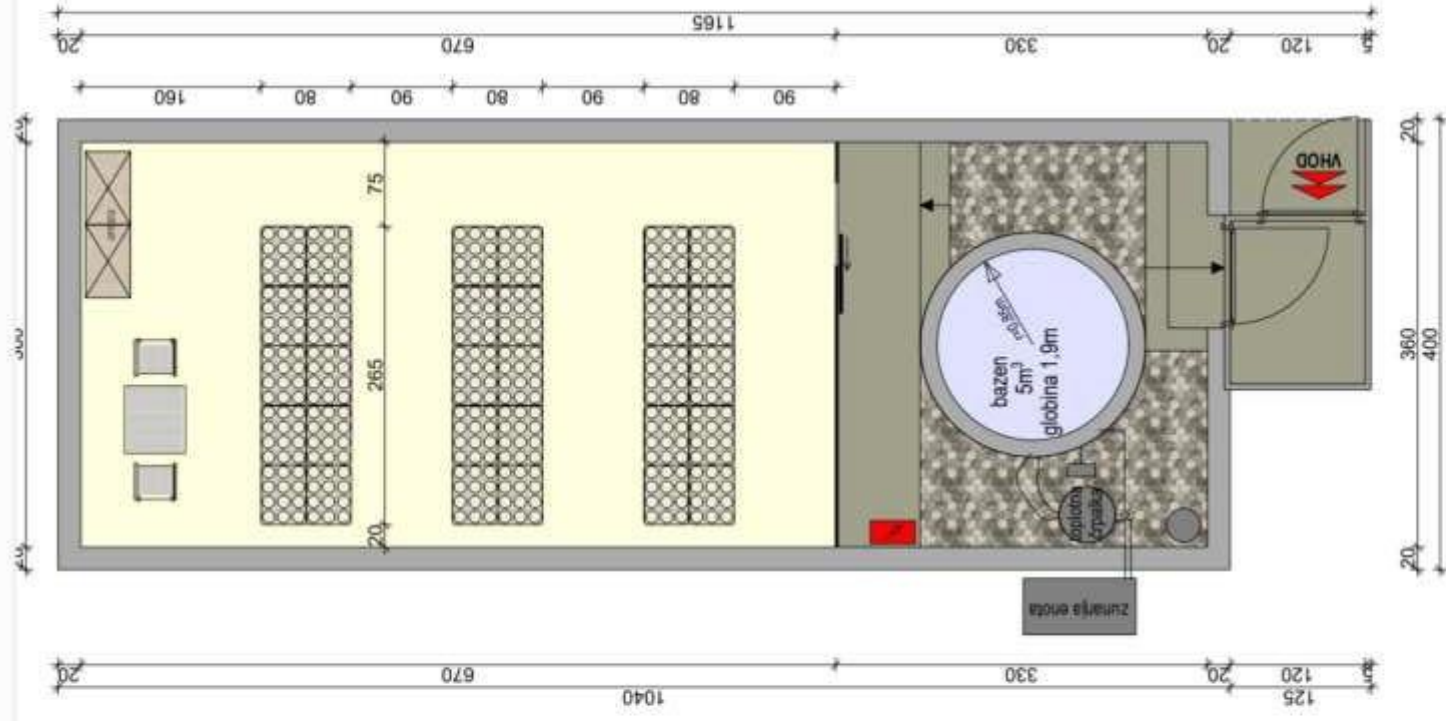

**PREREZ RASTLINJAKA**  
merilo 1:50

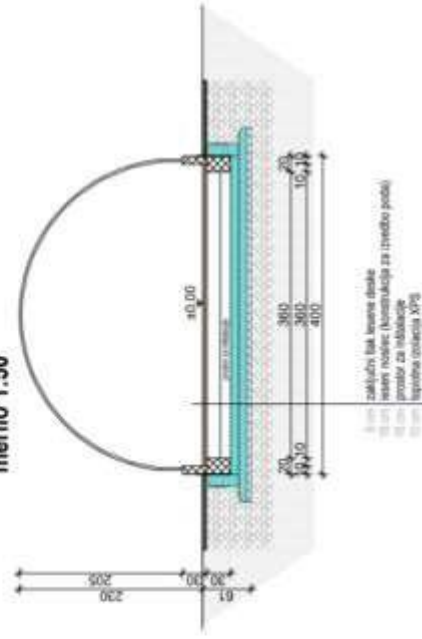



Thank you



Addryn LLC  
+385953750737 GSM/WhatsApp  
[info@addryn.com](mailto:info@addryn.com)

Representative for the UK and Spain  
Erminio Kotlar  
+61480335586 GSM/WhatsApp

## SATILU AGF30 IN ICF

- **Has 900 ICF-STAKE-SATILU-AGF30.**
- One stake has a price of 250 EUR.
- 20% of the payment for the stake is used:
  - 10% to prepare the project/products,
  - 10% to build an ICF network.
- 80% from the payment for the stake is used to place the project/products on the prepared location.
- Per installation **of SATILU-AGF30** per stake is paid 50 EUR.
- **6 SATILU-AGF30** needs to be sold for a stake in one ICF-STAKE-SATILU-AGF30 to be returned.
- When selling more than 6 pieces of **SATILU-AGF30**, earnings per ICF-STAKE-SATILU-AGF30 are paid until the paid earnings exceed 1,250 EUR.
- All obligations and rights under ICF-STAKE-SATILU-AGF30 are defined in the SPA agreement that is an integral part of the purchase of each ICF-STAKE-SATILU-AGF30.

